



CLEMCO
The Performance System

TECHNICAL DATA SHEET

Note: For safe, efficient blasting, read and follow the owner's manual and seek training for everyone who will use this equipment.

Purpose

The Apollo 600 HP is designed for use with compressed air. It meets OSHA standards for respiratory protection and air noise limitations. The Apollo 600's full-helmet design protects the blast operator's head from rebounding abrasive and from job-site impact hazards.

The heavy-duty silver-grey cape protects the operator's neck, shoulders, and chest from rebounding abrasive.

Requirements for Operation

- Source of Grade D or better quality compressed breathing air, as defined by the Compressed Gas Association specification G-7.1
- Volume of compressed air for breathing: 15 cfm at 65 to 100 psi when using ACV; or 20 cfm at 90 to 100 psi when using either CAT or CCT
- A breathing-air filter, such as Clemco CPF, to remove oil mist, moisture, particles, and odors
- Protective clothing, hearing and eye protection

Description of Operation

The Apollo 600 includes a knob-adjustable suspension. The operator fits the helmet to his or her head by turning the suspension knob clockwise to enlarge and counter-clockwise to decrease size. The suspension fits head sizes 6.5 to 8. The adjustable chin strap holds the helmet in position on the operator's head.

The wide, full-view window provides an expansive field of vision. A series of lenses preserves the operator's clear view of the work surface and protects the operator from dust and abrasive in the ambient air. A replaceable fixed inner lens securely fits inside a molded rubber gasket. An intermediate lens protects the inner lens; and up to 3 tear-away (perforated) outer lenses complete the system. The tear-away lenses are removed one at a time to expose a clean lens beneath. The multi-lens system is held in place by a hinged frame with replaceable latch.

Description

The Apollo 600 HP is a type CE, continuous-flow, supplied-air respirator as defined by the National Institute for Occupational Safety and Health (NIOSH) for abrasive blasting to be used with a respirable compressed air source.



To suit differing customer needs, the respirator is available in several configurations with one of the following air control devices:

- Constant-flow Connector (CFC) – fixed air flow
- Air-control Valve (ACV) – adjustable air volume
- Cool-air Tube (CAT) – cools incoming breathing air
- Climate-control Tube (CCT) – heats and cools incoming air

All breathing-air valves have minimum and maximum flow points as specified by OSHA.

A flexible breathing tube maintains air flow between the inlet fitting on the operator's belt and a replaceable inlet fitting at the center rear of the helmet crown for maximum operator comfort and maneuverability. The tube contains specially-formulated sound-deadening materials to reduce noise levels of incoming air to 80 dBA.

The helmet is generously sized to allow ear plugs or ear muffs and safety glasses or goggles as needed.

Incoming air enters the system through the air control device on the operator's belt. It continues through the breathing-air tube to enter the helmet at the inlet fitting at the center rear of the helmet crown. An air-distribution channel guides air over the head to the operator's face.

Apollo 600 HP Supplied-Air Respirators

for use with compressed air supply

Stock Nos. 24001-24004

The incoming air to the respirator system maintains positive pressure inside the helmet. Exhaled air exits through the knit collar, which must fit snugly around the operator's neck. All helmet features work together to protect the operator from exposure to harmful dust and abrasive.

Advantages

- Expansive, 180° full-view window
- Multi-lens system with rugged, positive-latching window frame
- Built-in mini visor prevents media ingress between lenses
- User-friendly cape attachment system
- Zip-in-and-out washable inner collar
- Replaceable inlet fitting
- Replaceable window latch
- Generous interior dimension allows supplementary hearing and eye protection
- Optional rectangular lens

Approvals and Certification

The Apollo 600 HP is NIOSH-approved as a type CE, continuous-flow supplied-air respirator; approval number: TC-19C-130. The respirator is recognized by OSHA as having an assigned protection factor (APF) of 1000 times the permissible exposure limit (PEL) for lead dust. It also meets the American National Standards Institute (ANSI) requirement for industrial head protection as stated in ANSI 289.1-2003 as a Type I, Class G protective helmet.

NOTE: Prior to use, ensure that the Apollo, type CE, supplied-air respirator is appropriate for your specific blasting conditions and requirements.

Respirator Systems and Accessories

| Description | Stock No. |
|---|-----------|
| Apollo 600 HP | |
| Less Respirator Hose | |
| With CFC | 24001 |
| With ACV | 24002 |
| With CAT | 24003 |
| With CCT | 24004 |
| With 50 ft x 3/8" Respirator Hose | |
| With CFC | 24771 |
| With ACV | 24210 |
| With CAT | 24211 |
| With CCT | 24212 |
| With 50 ft x 3/8" Respirator Hose and CPF-20 Filter | |
| With CFC | 24772 |
| With ACV | 24213 |
| With CAT | 24214 |
| With CCT | 24215 |

Options and Accessories

| | |
|---|-------|
| Constant flow connector with belt | 21422 |
| Cool-air tube with belt | 04410 |
| Climate control tube with belt | 04411 |
| CPF-20 filter (for 1 to 2 operators) | 03578 |
| CPF-80 filter (for up to 4 operators) | 03527 |
| Carbon monoxide alarm, stationary CMS-1 | 23017 |
| Carbon monoxide alarm, portable CMS-2 | 22894 |
| Blast suit, heavy cotton/leather | |
| S (08920), M (08921), L (08922), XL (08923) | |
| XXL (24201), XXXL (24202) | |
| Blast suit, seasonal cotton/nylon | |
| M (22914), L (22915), XL (22916), XXL (22917) | |
| Leather gloves | 02243 |
| Clemco Do-rag | 23814 |
| Low pressure conversion kit | |
| Converts HP helmet to LP helmet | 24812 |
| Noise reduction ear muffs | 23886 |
| Outer lens, rectangular, .015" (pk of 25) | 24005 |

Related Clemco Literature

| | |
|--|-------|
| Contractor Series Catalog | 21385 |
| Abrasive Blasting Safety Practices Booklet (English) | 22090 |
| Blast Off 2 Booklet (English) | 09294 |
| Safety Equipment Product Study | 07764 |
| Apollo 600 HP Owner's Manual | 23930 |

Shipping Dimensions and Weights

| | |
|---|--------|
| Apollo 600 Respirator, 12 x 14 x 14 | 9 lbs |
| 50 ft x 3/8" Respirator Hose, 12 x 12 x 5 | 7 lbs |
| CPF-20 Breathing-air Filter, 21 x 20 x 10 | 21 lbs |

Authorized Distributor:

Replacement Parts

| Item | Description | Stock No. |
|------|---|-----------|
| 1. | Air control valve with belt | 100024 |
| 2. | Belt assembly, 2" | 04430 |
| 3. | Respirator hose, 3/8" x 25' (incl 00022 & 01020) [optional] .. | 04397 |
| 4. | Respirator hose, 3/8" x 50' (incl 00022 & 01020) [standard] .. | 04415 |
| 5. | Respirator hose, 3/8" x 100' (incl 00022 & 01020) [optional] .. | 04398 |
| 6. | Adaptor, 3/8" hose to 3/8" pipe | 00022 |
| 7. | Union, 3/8" hose to 3/8" hose | 01020 |
| 8. | Disconnect, 1/4" female | 00025 |
| 9. | Adaptor, 3/8" hose to 1/4" pipe | 01019 |
| 10. | Acoustical foam kit, sides | 04369 |
| 11. | Gasket, window | 23819 |
| 12. | Inner lens, .040" (pk of 5) | 04367 |
| 13. | Intermediate lens, .020" (pk of 5) | 24943 |
| | (pk of 25) | 04373 |
| 14. | Outer lens, .0075", perforated (pk of 25) | 04361 |
| 15. | Window frame assembly | 24012 |
| 16. | Chin strap | 04460 |
| 17. | Handle strap | 03623 |
| 18. | Suspension | 23802 |
| 19. | Suspension sweatband | 23817 |
| 20. | Clips, suspension, (pk of 4) | 24773 |
| 21. | Cape attachment band | 23801 |
| 22. | Cape, silver-grey, with red inner collar | 23818 |
| 23. | Breathing tube assembly w/swivel ends | 22811 |
| 24. | O-ring, 11/16" ID x 7/8" OD, 2 required | 22815 |
| 25. | Inner collar | 08740 |
| 26. | Window latch kit, includes base and screws | 24006 |
| 27. | Inlet fitting | 23804 |
| 28. | Chin strap holder kit (2 w/fasteners) | 24008 |
| 29. | Partition, air baffle | 23811 |

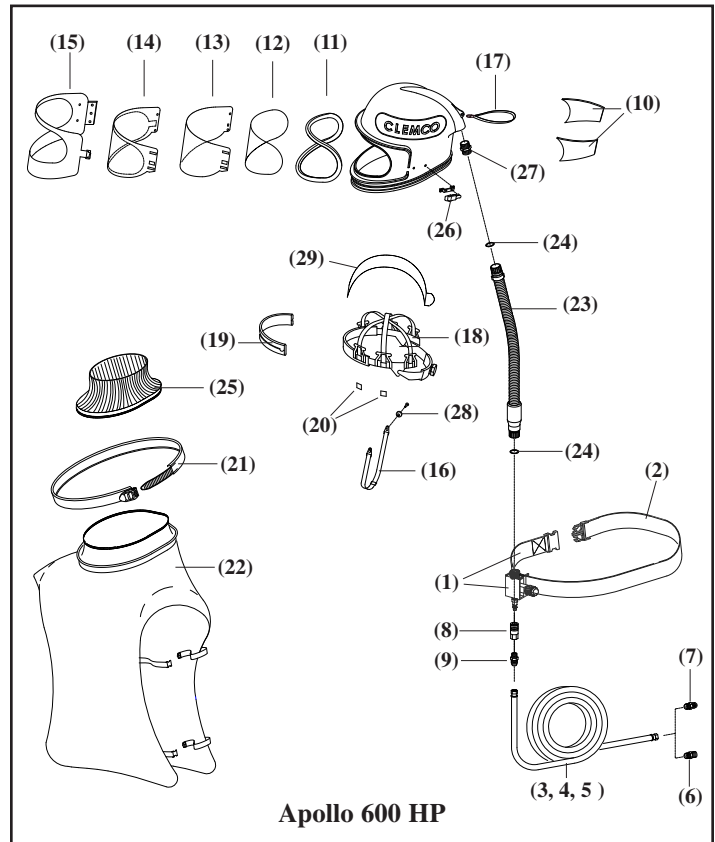

ISO 9001-2000 certified. Clemco is committed to continuous product improvement. Specifications are subject to change without notice.

© 2007 Clemco Industries Corp. • One Cable Car Drive • Washington, MO 63090 • Phone (636) 239-4300 • Fax (636) 239-0788

Stock No. 24181

www.clemcoindustries.com

Job No. 1195-1295 • Rev. C 06/07